

REV	DESCRIPTION	DATE

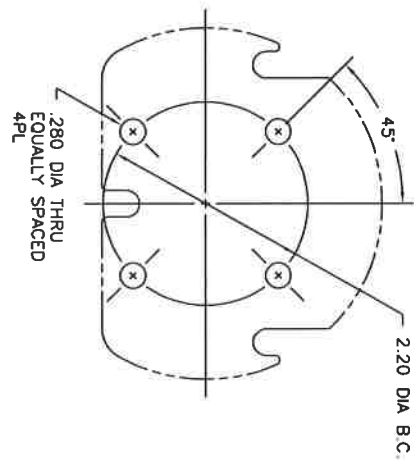
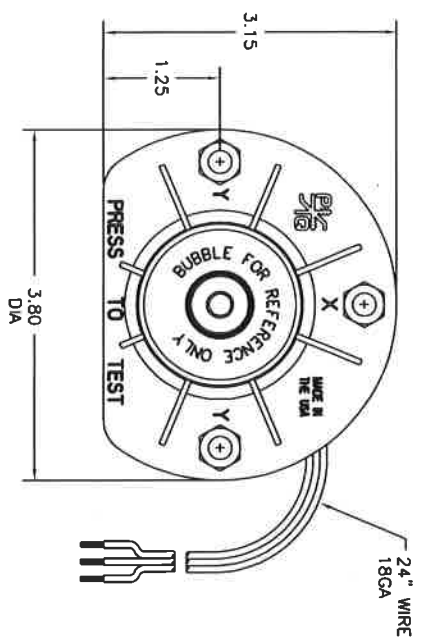

MOUNTING PATTERN
OPTION 1
 ALSO SUITABLE FOR WELDING TO MACHINE.

MODEL NUMBER: M400H-XX-XX

TRIP ANGLE	TIME DELAY
15 = 1.5°	05 = 0.5 SEC
20 = 2.0°	10 = 1.0 SEC
25 = 2.5°	15 = 1.5 SEC
30 = 3.0°	20 = 2.0 SEC
35 = 3.5°	25 = 2.5 SEC
40 = 4.0°	30 = 3.0 SEC
45 = 4.5°	35 = 3.5 SEC
50 = 5.0°	40 = 4.0 SEC
	45 = 4.5 SEC
	50 = 5.0 SEC

AVAILABLE IN 1/2 (0.5) DEGREE AND 1/2 (0.5) SECOND INCREMENTS ONLY.

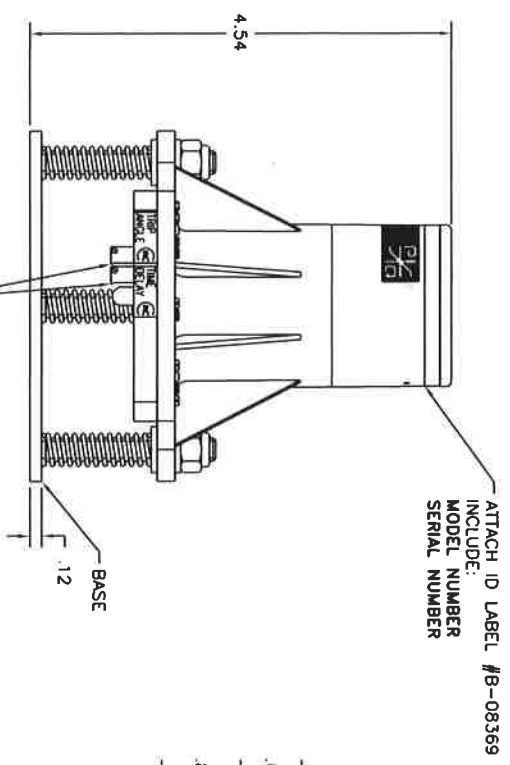

TRIP POINT &
 TIME DELAY ADJUSTMENT
 (CW INCREASES FUNCTION)

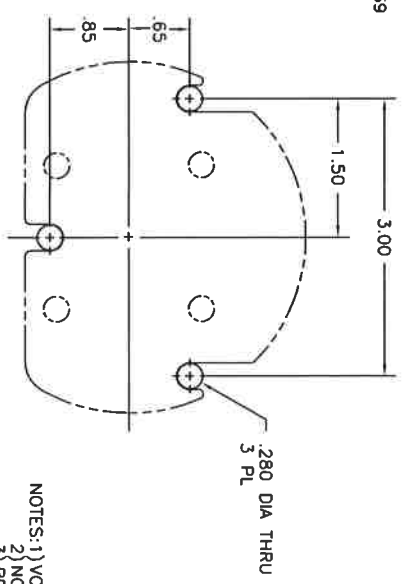

MOUNTING PATTERN
OPTION 2

- NOTES: 1) VOLTAGE SUPPLY IS TO BE 10-60VDC.
 2) NORMALLY CLOSED OUTPUT: 1.5AMPS @ VS.
 3) REF: TRIP ANGLE IS FIELD ADJUSTABLE FROM 1.5 TO 5 DEGREES. TRIP TIME DELAY IS FIELD ADJUSTABLE FROM 0 TO 5 SECONDS. FACTORY PRESET PER PART NUMBER.
 4) NEXT LOWER ASSEMBLY #C-11144.

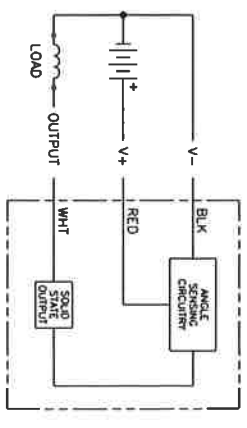

EQUIVALENT OUTPUT

WARNING: P-0 Control, Inc. shall not accept responsibility for installation, use, or repair of this device unless the user follows the instructions in this manual. The user must read and understand the instructions before attempting to install, use, or repair this device. Failure to follow the instructions could result in personal injury or property damage. P-0 Control, Inc. shall not be held liable for any damage or injury resulting from the use of this device.

	Part No.	C-11145	REV.
	Scale		1:1
Manufacturer	JCH	Product Designer	Date
Part No.	M400H-XX-XX	Installation DWG	
Scale			
Product Designer			
Date			02-21-00